

MAGNET

342707 yds. E.
919787 yds. N.

354166 yds. E. *P25*
919870 yds. N.

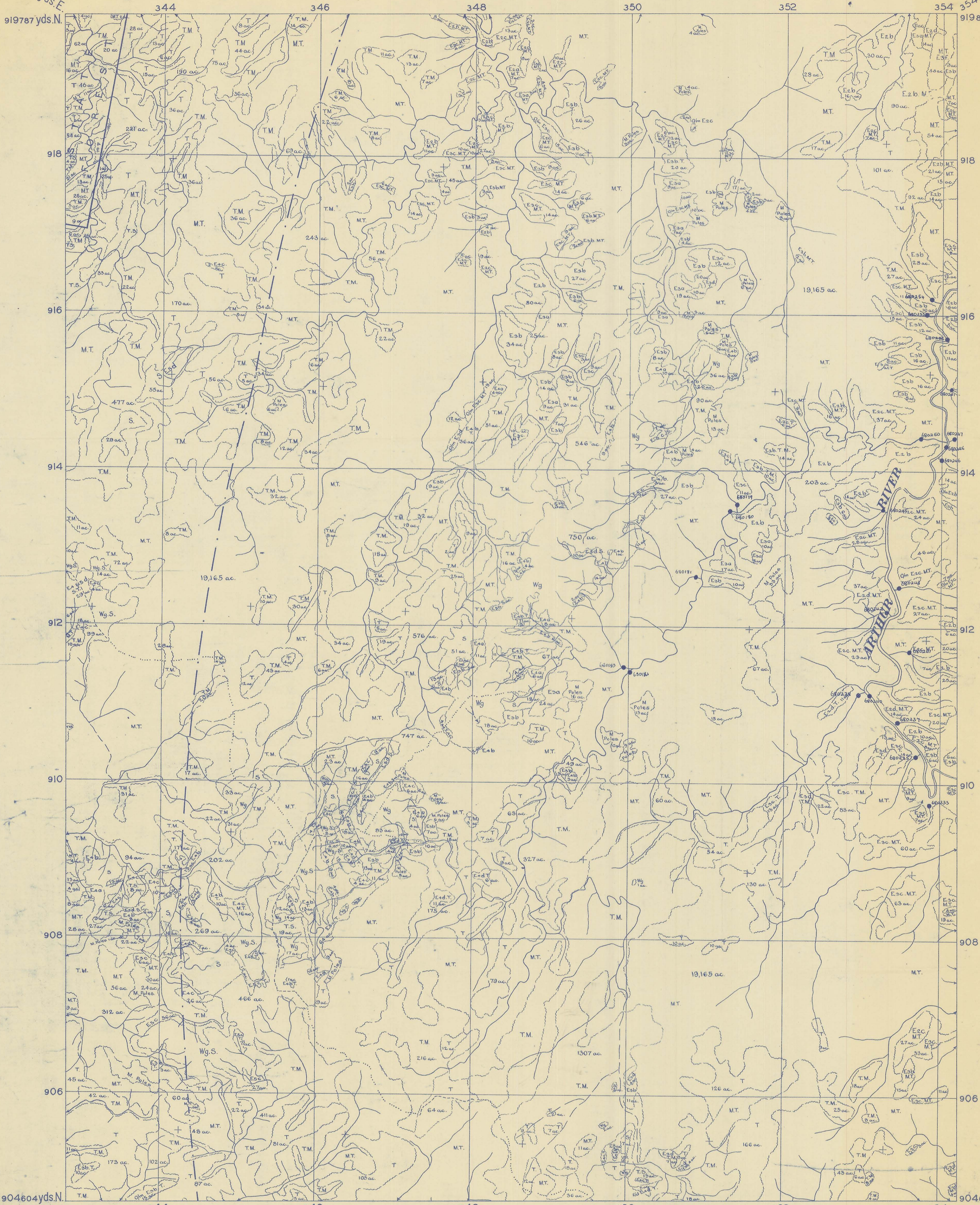

904604 yds. N.
342817 yds. E.

904688 yds. N.
354254 yds. E.

KEY TO PHOTOGRAPHS
47863 + + + + 47856
231 + + + + 36
43 + + + + 48
103 + + + + 108
48955 + + + + 48991
104 + + + + 6

KEY TO ADJOINING SHEETS
TROWUTTA
BALFOUR VALENTINES PEAK
CORINNA

OTHER FOREST TYPES

- M — Myrtle
- T — Secondary species
- V — Cultivation and pasture
- Vo — Orchard
- Vz — Rough grazing
- S — Scrub
- K — Bracken
- W — Wasteland
- Wg — Button grass, or healthy plain
- Wm — Mountain moor
- Wr — Bare ground, or rock
- Id — Fire damaged
- O/m — Over mature
- C/o — Cut over

Scale: 30 Chains to an Inch.

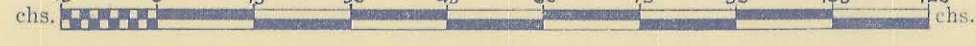

Form Line Interval feet

EUCALYPT TYPES

- E — Eucalypt Forest
- E1 — Mature Eucalypt Forest average height of dominants above 180 ft.
- E2 — " " " " from 135-180 ft.
- E3 — " " " " from 90-135 ft.
- E4 — " " " " from 50-90 ft.
- E5 — " " " " less than 50 ft.
- ER — Eucalypt Regrowth
- ERG — Eucalypt Seedling and Sapling Regrowth
- ERP — Eucalypt Pole Regrowth

DENSITY CLASSES (Mature Eucalypts only)

- CROWN COVER
- a — 70-100 per cent eucalypt crown cover
- b — 40-70 " " "
- c — 20-40 " " "
- d — 5-20 " " "
- f — less than 5 " " "

CONVENTIONAL SIGNS

- All weather roads
- Summer roads
- Tracks
- Trains
- Probable track course
- Private property boundaries
- State forest boundaries
- APPM Concession boundary
- Sawmills
- Old mill sites
- Fire lookout stations
- Forestry Comm. trig. stations
- Other trig. stations

DATE OF PHOTOGRAPHY JANUARY 1953
DATE OF PRODUCTION FEBRUARY 1956

5 cm

Compiled from Air Photographs
by
Mapping Branch
Forestry Commission
Tasmania